

| CONDUCTOR ALUMINIUM CABLE | CATALOG | B | L | TOOL |
|---------------------------|-----------|-----|------|------|
| 12 AWG SOL | YS12WA-G1 | .45 | 1.03 | 398 |
| 12 AWG STR | YS12A-G1 | .45 | 1.03 | 396 |
| 10 AWG SOL. | YS10WA-G1 | .50 | 1.12 | 397 |
| 10 AWG STR | YS10A-G2 | .50 | 1.12 | 397 |

| REV | DATE | DESCRIPTION | ECO | BY | C'H'K. |
|-----|------------|---------------------|-------|----|--------|
| A | 03/28/2016 | REDRAWN TO INVENTOR | 43332 | PK | MB |

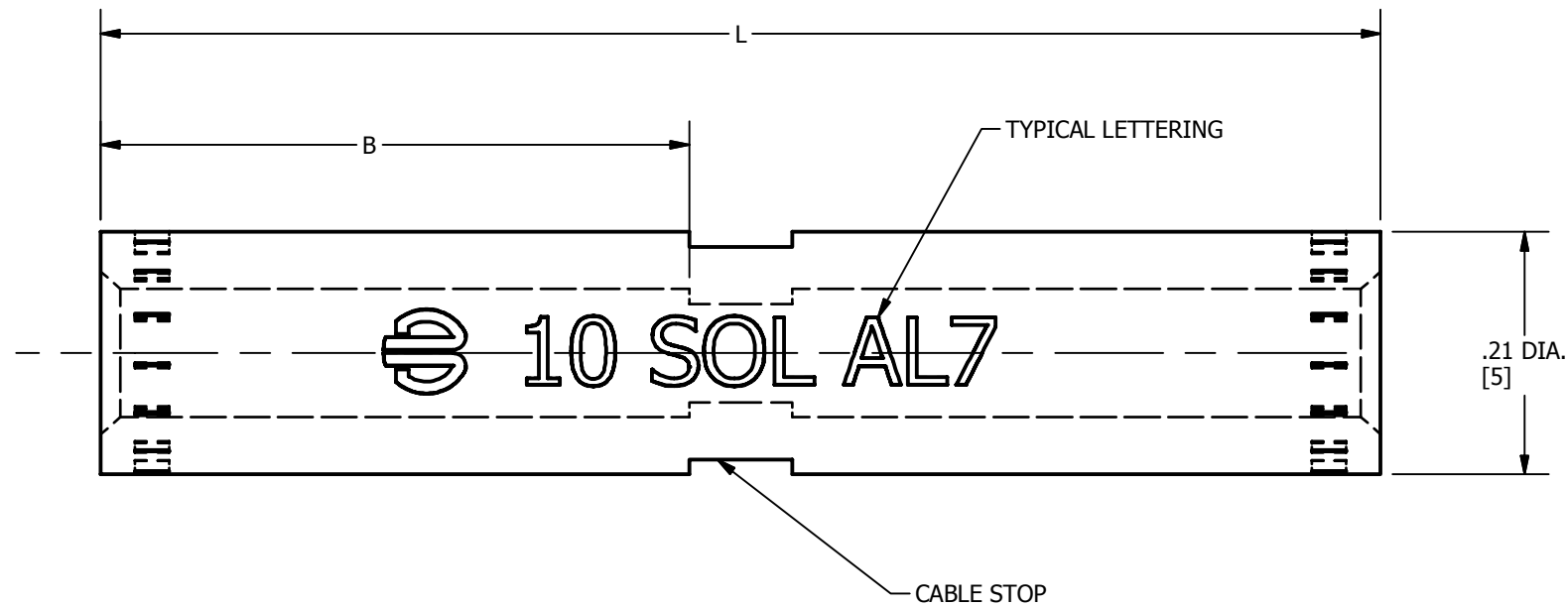

NOTES:

1. BARRELS PARTIALLY FILLED WITH PENETROX™ FOIL.
 2. REMOVE ALL EXCESS PENETROX™ FROM CONNECTOR AND ADJACENT CONDUCTOR INSULATION PRIOR TO TAPING.
 3. INSTALLATIO TOOL : MR8-27 (1 LONGITUDINAL INDENT, EACH END)
 4. MATERIAL: ALUMINIUM TUBING.
FINISH: UNPLATED.
- 5 UL LISTED SPlicing WIRE CONNECTOR.

| | | | |
|---|--|----------------------------------|--|
| TO ORDER BURNDY® PRODUCTS CALL | | HYLINK™ (ALUMINIUM) | |
| UNITED STATES 1-800-346-4175 (LONDONDERRY, NH) | | ITEM NO: SEE TABLE | |
| CANADA: 1-800-361-6975 (QUEBEC) 1-800-387-6487 (ALL OTHER PROVINCES) | | CAT. NO: YS--A-G1 | |
| FOR PRODUCT INFO: http://www.burndy.com | | DRAWN BY: PRAVEEN K 03/28/16 | |
| | | CHECKER: MANIKANDAN B 03/29/16 | |
| | | DSN APRVL: R. ROMAN 04/04/16 | |
| | | MFG APRVL: J. ISHERWOOD 04/04/16 | |
| | | QA APRVL: T. WATTS 04/05/16 | |
| | | MKT APRVL: B. MICHAUD 04/05/16 | |
| | | PROD FAM: -- | |
| | | DRAWING NO | |
| | | REV | |
| | | PROJECT #: -- | |
| | | SIZE | |
| | | SC081377 | |
| | | A | |
| | | DOCUMENT TYPE: SALES | |
| | | REL LEVEL: Released | |
| | | B | |
| | | SHEET 1 OF 1 | |